



**MIMIC  
AEROLED**



SSEL

## PRODUCT SPECIFICATION

SSEL

**Materials** Lens-Tempered glass, Housing-Al

**Ambient operating temperature**

$-40^{\circ}\text{C} \leq \text{Tamb} \leq +60^{\circ}\text{C}$

**Explosion protection rating** Ex d IIC T6, IP66

**Certificates** KIMM

**Housing standard color** MUNSELL No. 7.5BG 7/2

**Cable entry** 1/2" NPT

- Suitable for helideck and other dangerous areas that require a perimeter light
- Structure minimizing the projection of lens, can be protected from damage by external impact
- Product structure with 100mm height meets the IMD regulation condition
- Aluminum housing provides excellent durability
- Terminal for power wiring located inside of the housing

### SSEL Explosion Proof LED Perimeter Light

Model number	Voltage	Current	Certificates	Weight	Color
SSEL	DC12V	460mA		2.54kg	● R-Red
	DC24V	250mA		2.54kg	● A-Amber
	AC110V	40mA		2.54kg	● G-Green
	AC220V	40mA		2.54kg	● B-Blue

### Technical Diagram

·SSEL

Units: mm

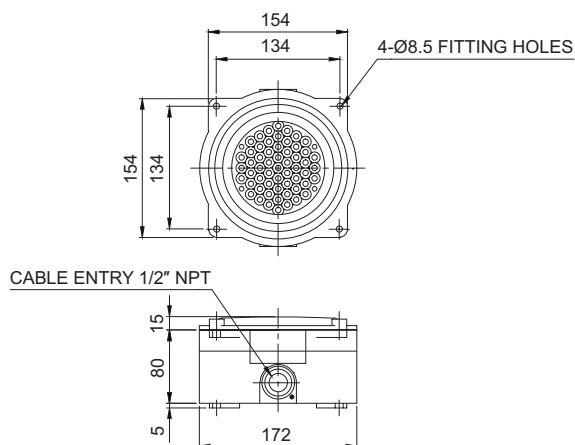

### Customization

- Explosion proof cable gland attached type available (Standard type does not come with explosion proof cable gland)
- 2 ways cable entries
- Customized cable entry(3/4" NPT, M20×1.5, M25×1.5) available

### Ordering Specification

<b>SSEL</b>	-	<b>220</b>	-	<b>R</b>
[Model number] SSEL		[Voltage] 12-DC12V 24-DC24V 110-AC110V 220-AC220V		[Color] ● R-Red ● A-Amber ● G-Green ● B-Blue